

Con manovra di soccorso
With manual override

Coppie elevate
High torques

Facile da installare
Easy to install

Ø59 CDE 59

Motore tubolare Ø59 con finecorsa meccanico filare e manovra di soccorso idoneo per applicazioni su tende da sole e tapparelle di dimensioni e peso elevati.
Tubular motor Ø59 with mechanical end limit switch and manual override suitable for awnings and rolling shutters with heavy weight and large size dimensions.

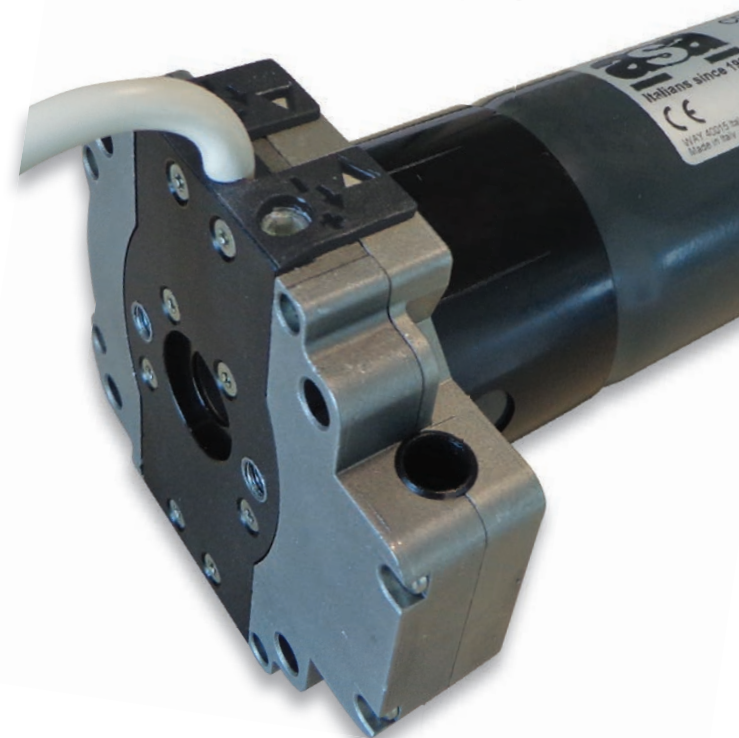
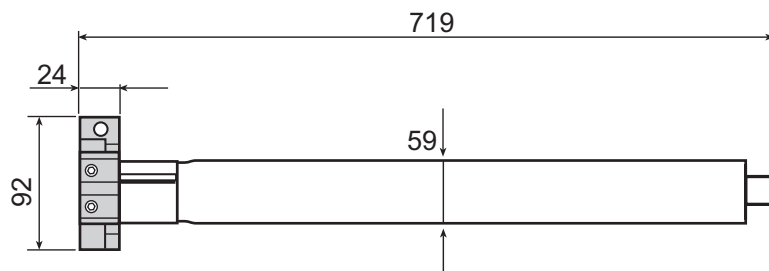

Caratteristiche tecniche / *Technical features*

CODICE CODE	DESCRIZIONE DESCRIPTION	COPPIA TORQUE	VELOCITÀ SPEED	GIRI FC LS ROUNDS	ASSORBIMENTO CONSUMPTION	ALIMENTAZIONE POWER SUPPLY	GRADO DI PROT. PROT. DEGREE	LUNGHEZZA LENGTH	PESO MOTORE MOTOR WEIGHT	IMBALLO PACKAGE	CERTIFICAZIONE CERTIFICATION
2252094	CDE 80-12	80 Nm	12 Rpm	27	380 W	230 V ~ / 50 Hz	IP 44	719 mm	5,67 Kg	1 pz/pc	CE
2253102	CDE 100-12	100 Nm	12 Rpm	27	485 W	230 V ~ / 50 Hz	IP 44	719 mm	5,84 Kg	1 pz/pc	CE
2254085	CDE 120-8	120 Nm	8 Rpm	27	350 W	230 V ~ / 50 Hz	IP 44	719 mm	6,13 Kg	1 pz/pc	CE

Applicazione Application

Tende da sole
Awnings



Dati prestazionali / Performance data

CODICE CODE	DESCRIZIONE DESCRIPTION	COPPIA TORQUE	VELOCITÀ SPEED	MOTORE MOTOR	TUBO TONDO ROUND TUBE	2 BRACCIA 2 ARMS	4 BRACCIA 4 ARMS	6 BRACCIA 6 ARMS
						SPORGENZA PROJECTION	SPORGENZA PROJECTION	SPORGENZA PROJECTION
2252094	CDE 80-12	80 Nm	12 Rpm	Ø 59	Ø 78	3,5 m - 4 m	3 m - 3,5 m	2 m - 2,5 m
2253102	CDE 100-12	100 Nm	12 Rpm	Ø 59	Ø 78	4,5 m	4 m	3 m - 3,5 m - 4 m
2254085	CDE 120-8	120 Nm	8 Rpm	Ø 59	Ø 78	/	4,5 m	4,5 m

Applicazione Application

Tapparelle
Rolling shutters



Dati prestazionali / Performance data

CODICE CODE	DESCRIZIONE DESCRIPTION	COPPIA TORQUE	VELOCITÀ SPEED	MOTORE MOTOR	TUBO OTT. OCTO TUBE	PESO SOLLEVATO LIFTED WEIGHT
2252094	CDE 80-12	80 Nm	12 Rpm	Ø 59	Ø 70	81 - 90 Kg
2253102	CDE 100-12	100 Nm	12 Rpm	Ø 59	Ø 70	91 - 115 Kg
2254085	CDE 120-8	120 Nm	8 Rpm	Ø 59	Ø 70	116 - 140 Kg

Accessori Accessories

Staffe Brackets



p.76

Adattatori Adapters



p.82

Meccanici Mechanicals



p.66 - 85

Controlli Controls



p.67

Download

Selezionare 1 codice
QR alla volta
Select 1 single QR
code each time

Manuale d'uso Instruction manual



Dichiarazione di conformità Conformity declaration





Motori tubolari
Tubular motors

CDE-R - CDE 45 - CDE 59

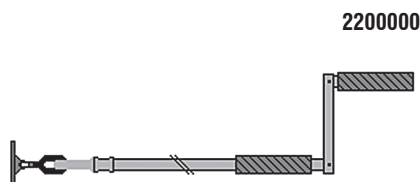

2200000

Asta snodata
Crack handle

CONF. 1 PZ / PACK. 1 PC



2200008

Asta rigida con gancio
Rigid handle with hook

CONF. 1 PZ / PACK. 1 PC



2200092

Piastra occhiello a cassonetto a 45°
uscita occhiello dal lato inferiore
45° joint with eye.
Rising from the box floor.

CONF. 1 PZ / PACK. 1 PC



2200093

Piastra occhiello a cassonetto snodato a 90°. *Uscita occhiello dal lato frontale del cassonetto*
90° joint with eye.
Rising from the box front.

CONF. 1 PZ / PACK. 1 PC



2204005

Barra quadra con occhiello
L = 6 cm
Square joint with short eye
solar protection applications. L = 6cm

CONF. 1 PZ / PACK. 1 PC

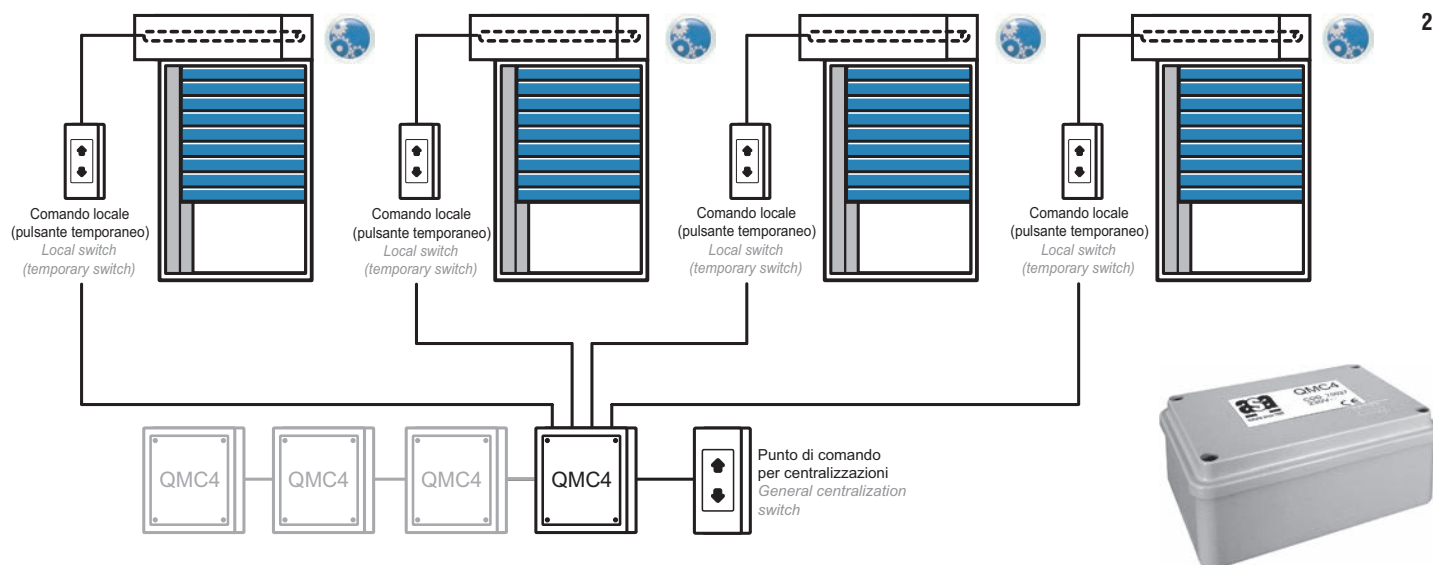

2212004

QMC4

Centrale di controllo per il collegamento in parallelo di motori meccanici filari (max 4 motori per centrale).
Control unit for mechanical wired motors connected in parallel (max 4 motors for each control unit).

CONF. 1 PZ / PACK. 1 PC



2211016

Go-er

Ricevente esterna per il controllo via radio di motori filari (1 motore per ricevente).
Compatibile con tutti i controlli radio ASA

*External receiver for radio control of wired motors (1 motor for each receiver).
Compatible with all ASA radio controls.*

CONF. 1 PZ / PACK. 1 PC



2211149

Go-er platine

Ricevente esterna per il controllo via radio di motori filari, specifica per applicazioni su cassonetto (1 motore per ricevente).
Compatibile con tutti i controlli radio ASA

*External receiver for radio control of wired motors specific for cassette application (1 motor for each receiver).
Compatible with all ASA radio controls.*

CONF. 1 PZ / PACK. 1 PC

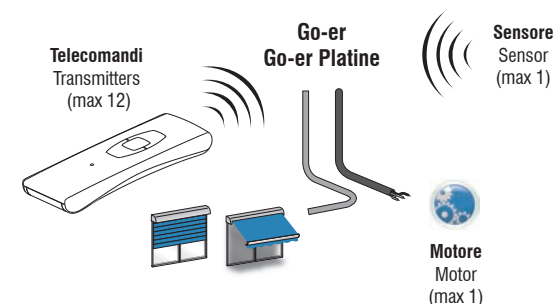

Motori tubolari Tubular motors

ETR 59 - ETR-A 59 - CD 59

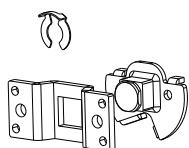

2205025



Staffa con perno quadrato
Bracket with square pin

CONF. 5 PZ / PACK. 5 PCS

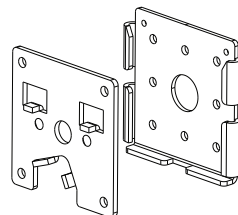

2205027



**Staffa scorrevole
interasse 48 box**
*Sliding bracket
center to center 48 box*

CONF. 5 PZ / PACK. 5 PCS

Motori tubolari Tubular motors

CDE 59 con manovra di soccorso / *with manual override*

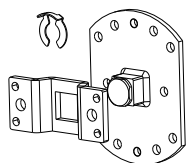

2200160



**Staffa orientabile con perno quadrato
a due posizioni e relativa sella**
Revolving bracket with two positions square pivot

CONF. 5 PZ / PACK. 5 PCS

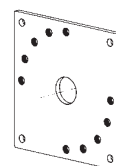

2200043

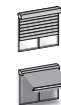

Staffa 100 x 100
100 x 100 bracket plate

CONF. 5 PZ / PACK. 5 PCS

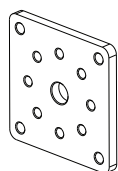

2200161



Staffa quadrata interasse 48 box
Square bracket 48 center to center box

CONF. 5 PZ / PACK. 5 PCS

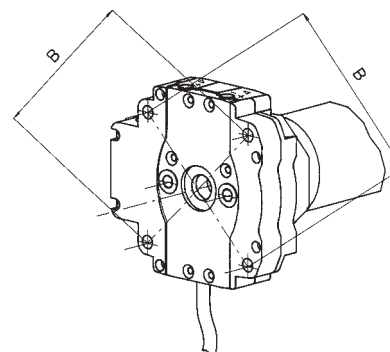

**Interasse B: da utilizzare tassativamente
per i motori con coppia $\geq 80\text{Nm}$.**
*Interax distance B: to fix motors with nominal
torque $\geq 80\text{Nm}$.*



Motori tubolari
Tubular motors

ETR 59 - ETR-A 59 - CD 59 - CDE 59



Ø70 x 1,5 mm Corona e ruota / Crown and wheel

2205024

**Adattatori per tubo ottagonale
Metallo**
*Adapters for octagonal rolling tube
Metal*

CONF. 5 PZ / PACK. 5 PCS

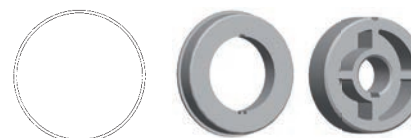

Ø102 x 2 mm Corona e ruota / Crown and wheel

2200155

**Adattatori per tubo rotondo
Metallo**
*Adapters for round rolling tube
Metal*

CONF. 5 PZ / PACK. 5 PCS



Ø70 x 1,5 mm Corona e ruota / Crown and wheel

2200159

**Adattatori per tubo rotondo
Metallo**
*Adapters for round rolling tube
Metal*

CONF. 5 PZ / PACK. 5 PCS



LP Ø89 x 1 mm Corona e ruota / Crown and wheel

2200158

**Adattatori per tubo deprat - F5039
Metallo**
*Adapters for deprat rolling tube - F5039
Metal*

CONF. 5 PZ / PACK. 5 PCS



Ø85 x 1,5 mm Corona e ruota / Crown and wheel

2200156

**Adattatori per tubo rotondo
con ogiva tonda - Metallo**
*Adapters for round
with groove rolling tube - Metal*

CONF. 5 PZ / PACK. 5 PCS



Ø80 x 1/1,2 mm Corona e ruota / Crown and wheel

2200157

**Adattatori per tubo ZF80
Metallo**
*Adapters for ZF80 rolling tube
Metal*

CONF. 5 PZ / PACK. 5 PCS



Ø78 x 1,5 mm Corona e ruota / Crown and wheel

2205026

**Adattatori per tubo rotondo
con ogiva tonda 14 mm - Metallo**
*Adapters for round with 14 mm groove
rolling tube - Metal*

CONF. 5 PZ / PACK. 5 PCS



Motori tubolari
Tubular motors

ETR 59 - CD 59 - CDE 59

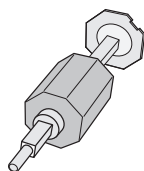

2200026

**Fondello in materiale plastico con
perno tondo per tubo ottagonale Ø 70**
*Adjustable plastic cap with pivot for
Ø 70 octagonal rolling tube*

CONF. 1 PZ / PACK. 1 PCS

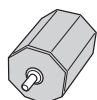

2200024

**Fondello in materiale plastico
con perno tondo per
tubo ottagonale Ø 70**
*Plastic cap with pivot for Ø 70
octagonal rolling tube*

CONF. 1 PZ / PACK. 1 PC

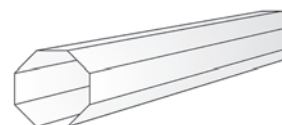

2200017

Barra 3m tubo ottagonale Ø 70
3 m Ø 70 octagonal tube

CONF. 4 PZ / PACK. 4 PCS

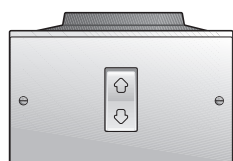

2210003 Pulsantiera temporanea (incasso)
Temporary position switch (wall mounted)

CONF. 1 PZ / PACK. 1 PC



2210011 Pulsantiera in box stagno temporanea (parete)
Waterproof momentary position switch (surface mounted)

CONF. 1 PZ / PACK. 1 PC



2210004 Pulsantiera temporanea (parete)
Temporary position switch (surface mounted)

CONF. 1 PZ / PACK. 1 PC



2210012 Mini pulsantiera temporanea (parete)
Temporary position mini switch (surface mounted)

CONF. 1 PZ / PACK. 1 PC



2210007 Pulsante stabile
Fixed position switch

CONF. 1 PZ / PACK. 1 PC



2210013 Mini pulsantiera stabile (parete)
Fixed position mini switch (surface mounted)

CONF. 1 PZ / PACK. 1 PC



2210008 Pulsante temporaneo
Temporary position switch

CONF. 1 PZ / PACK. 1 PC